

JMS AG
 Jet Maintenance & Service
 Rainer-Haungs-Strasse 42
 77933 Lahr/Germany
 Phone +49 (7821) 9 94 69 – 0
 Fax +49 (7821) 9 94 69 – 100



Internet: <http://www.jms.aero/>
 eMail: <mailto:sales@jms.aero>

HRB 705130 Amtsgericht Freiburg i.Br.
 VAT Reg No/USt.-IdNr.: DE270217003

Doc. No. TDS J-TOWhead-versa1_R01.docx

Datasheet:

p/n: J-TOWhead-versa1

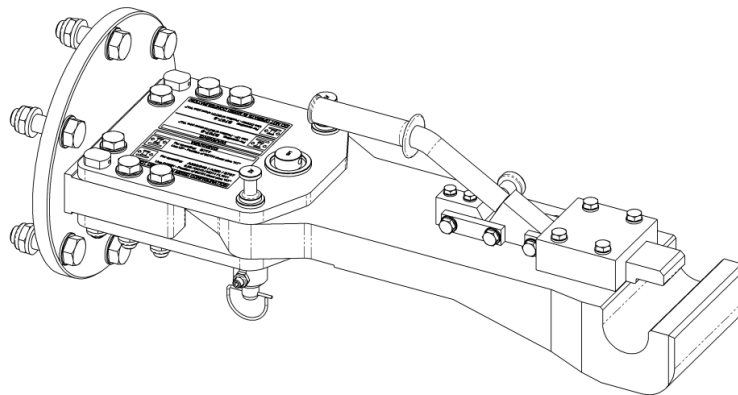

Shear pins in DOWN position

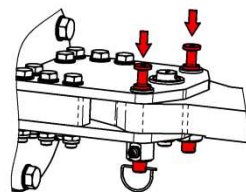

With Shearpin "AT" installed
 Configuration A330/340 and B767
 (also IL96 and DC10/MD11 / L1011)

With Shearpin "AU" installed
 Configuration B787-8

Shear pins in UP position

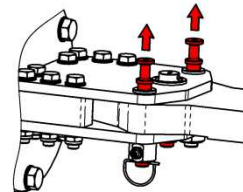

With Shearpin "AT" installed
 Configuration B777

With Shearpin "AU" installed
 Configuration B787-9

Standard features:

- Push/Pull and torque shear pins, replaceable without using tools.
- FOD-Protection device:
No shear pin debris will be lost in case of shear pin fracture!
- 6 spare shear pins included
- Retaining pin
- Automatic locking mechanism
- All steel parts corrosion-resistant
- Incl. label aircraft-type

Options (at extra charges):

- Revolving tow head $\pm 10^\circ$ → Option AD

Documentation:

- Technical manual incl. illustrated spare parts list
- COC Certificate of Conformity
- CE Declaration of Conformity (if applicable)

Aircraft application:

- | | |
|------------------|-----------|
| • A330 / A340 *1 | • IL96 |
| • A350-900 | • DC10 *2 |
| • B767 | • MD11 *2 |
| • B777 | • L1011 |
| • B787 | |

Shear pins:

- Push/Pull and Torque
20-00230-0020-022 "AT" (all, without B787)
20-00230-0020-122 "AU" (only B787)
- 00.40060.0008 "L-FB" Retaining pin

Net weight:

- 86 kg / 189 lbs

Shipping information incl. packing:

Approx. Weight	Approx. shipping Dims l x w x h	Approx. Volume
[kg]	[mm]	[m ³]
113	800 x 350 x 470	0,13
[lbs]	[inch]	[ft ³]
250	31.5 x 14 x 18.5	4,6

*1 = Not suitable for A340 -500/ -600.

*2 = For DC10 & MD11 revolving tow head required

We reserve the right to update this datasheet at any time w/o prior