

JMS AG
 Jet Maintenance & Service
 Rainer-Haungs-Strasse 42
 77933 Lahr/Germany
 Phone +49 (7821) 9 94 69 – 0
 Fax +49 (7821) 9 94 69 – 100



Internet: <http://www.jms.aero/>
 eMail: <mailto:sales@jms.aero>

HRB 705130 Amtsgericht Freiburg i.Br.
 VAT Reg No/USSt.-IdNr.: DE270217003

Doc. No. TDS J-TOWversa1-S_R03.docx

Datasheet:

p/n: J-TOWversa1-S

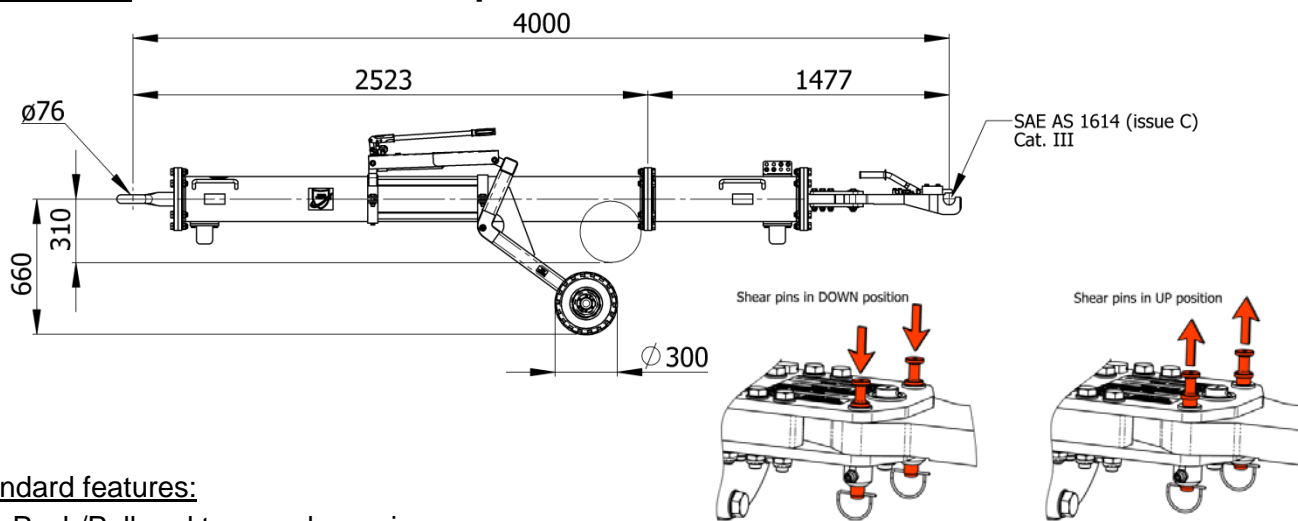

Standard features:

- Push/Pull and torque shear pins, replaceable without using tools.
- FOD-Protection device:
No shear pin debris will be lost in case of shear pin fracture!
- 4 spare shear pins included
- Retaining pin
- Air-inflated tires
- Hydraulically height adjustable undercarriage
- Steel tube
- Skydrol resistant paint
- Standard colors: yellow RAL 1007 (tube), black RAL 9004 (undercarriage)

Aircraft application:

- A330 / A340 *1
- A350-900
- B767
- B777
- B787
- IL96
- DC10 *2
- MD11 *2
- L1011

*1 = Not suitable for A340 -500/ -600.

*2 = For DC10 & MD11 revolving tow head required

Net weight:

- 305 kg / 672 lbs

Shipping information incl. packing:

Approx. Weight	Approx. shipping Dims l x w x h	Approx. Volume
[kg]	[mm]	[m ³]
380	2650 x 1000 x 770	2,0
[lbs]	[inch]	[ft ³]
837	104 x 39 x 30	70.6

Options (at extra charges):

- Puncture-proof tires
- Floating axle
- Revolving tow head $\pm 10^\circ$ *2
- Revolving tow eye
- Revolving tow eye with shock absorber
- Customized color for towbar tube i.a.w. RAL coding scheme

Documentation:

- Technical manual
incl. illustrated spare parts list
- COC Certificate of Conformity
- CE Declaration of Conformity (if applicable)

Shear pins:

- Push/Pull and Torque
20-00230-0020-022 "AT" (all, without B787)
20-00230-0020-122 "AU" (only B787)
- 00.40060.0008 "L-FB" Retaining pin

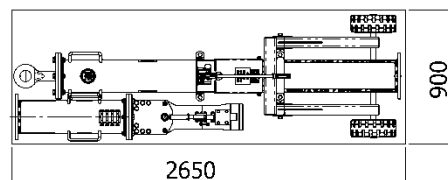
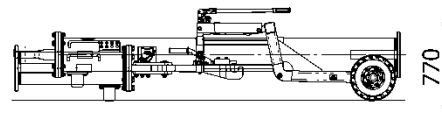

We reserve the right to update this datasheet at any time w/o prior notice!