

**Datasheet:**

**p/n: J-TOWhead-versa3**

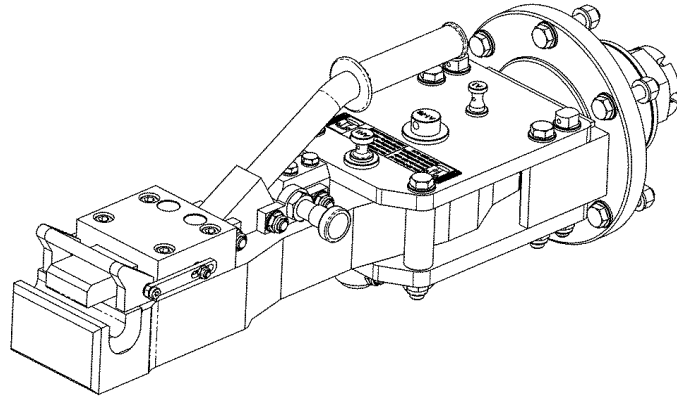

**One** shear pin for operating **B737 -300 to -900 / Max-7/ -8/ -9 and A320 / A320neo family** at different shear protection values! Fast and easy convertible by locking shear pin in up or down position.

Further aircraft (see “aircraft applications”) can be operated by just replacing dedicated shear pins.

**No tools required!**

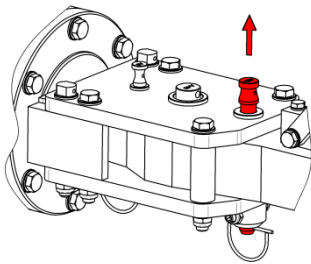

Configuration  
 B737 -800 /-900 / MAX-8 /-9

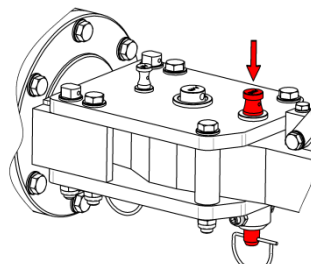

Configuration  
 B737-300 to -700 / MAX-7  
 A320 / A320neo family

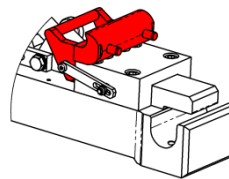

Configuration  
 A320

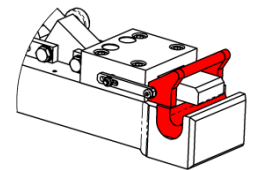
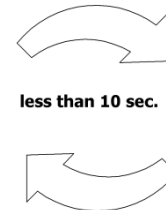

Configuration  
 B737

**Standard features:**

- Push/Pull and torque shear pins, replaceable without using tools. (add. 2x Push/Pull and 2x Torque spare shear pins included)
- Retaining pin, replaceable without using tools.
- FOD-Protection device:  
 No shear pin debris will be lost in case of shear pin fracture!
- Automatic locking mechanism
- Revolving tow head  $\pm 10^\circ$   
 (required for A318/A319/A320/A321 due to NLG at  $9^\circ$  angle)
- All steel parts corrosion-resistant
- Incl. label aircraft type

**Aircraft application:**

- A320 / A320neo family
  - B737 -300 to -700 / MAX -7
  - B737 -800/ -900 / MAX -8 /-9
  - Sukhoi Super Jet - SSJ100\*
  - Bombardier - CS100 / CS300\*
  - Irkut - MC-21 -200/-300\*
  - Comac - C919\*
- \* dedicated shear pins required – see “shear pins” on page 2/2

Continued on following page

**JMS AG**  
Jet Maintenance & Service  
Rainer-Haungs-Strasse 42  
77933 Lahr/Germany  
Phone +49 (7821) 9 94 69 – 0  
Fax +49 (7821) 9 94 69 – 100



Internet: <http://www.jms.aero/>  
eMail: <mailto:sales@jms.aero>

HRB 705130 Amtsgericht Freiburg i.Br.  
VAT Reg No/USSt.-IdNr.: DE270217003

Doc. No. TDS\_J-TOWhead-versa3\_R02.docx  
Page 2 of 2

## Datasheet:

## p/n: J-TOWhead-versa3

### Shear pins / Retaining pins:

Standard shear pins for use with **A320 and B737**

- 20-01070-0020-022 "AN1" for Push/Pull
- 20-00730-0020-022 "A1" for Torque
- 20-01070-0020-021 "A1-FB" Retaining pin

Standard shear pins for use with **SSJ100**

- 20-01130-0020-022 "AP2" for Push/Pull
- 20-00730-0020-022 "A1" for Torque
- 20-01130-0020-021 "AP1-FB" Retaining pin

Standard shear pins for use with **CS100 / CS300**

- 20-01080-0020-022 "BC" for Push/Pull
- 20-01080-0020-025 "BD" for Torque
- 20-01080-0020-021 "BC-FB" Retaining pin

Standard shear pins for use with **MC-21**

- 20-01040-0020-022 "BA" for Push/Pull
- 20-01040-0020-025 "BD" for Torque
- 20-01040-0020-021 "BA-FB" Retaining pin

Standard shear pins for use with **C919**

- 20-01120-0020-022 "BE" for Push/Pull
- 20-01120-0020-025 "BF" for Torque
- 20-01120-0020-021 "BE-FB" Retaining pin

### Documentation:

- Technical manual  
incl. illustrated spare parts list
- COC Certificate of Conformity
- CE Declaration of Conformity (if applicable)

### Net weight:

- 55 kg / 121 lbs

### Shipping information incl. packing:

Approx. Weight	Approx. shipping Dims l x w x h	Approx. Volume
[kg] 79	[mm] 1200 x 600 x 300	[m³] 0,22
[lbs] 174	[inch] 47 x 23 x 12	[ft³] 7.7